

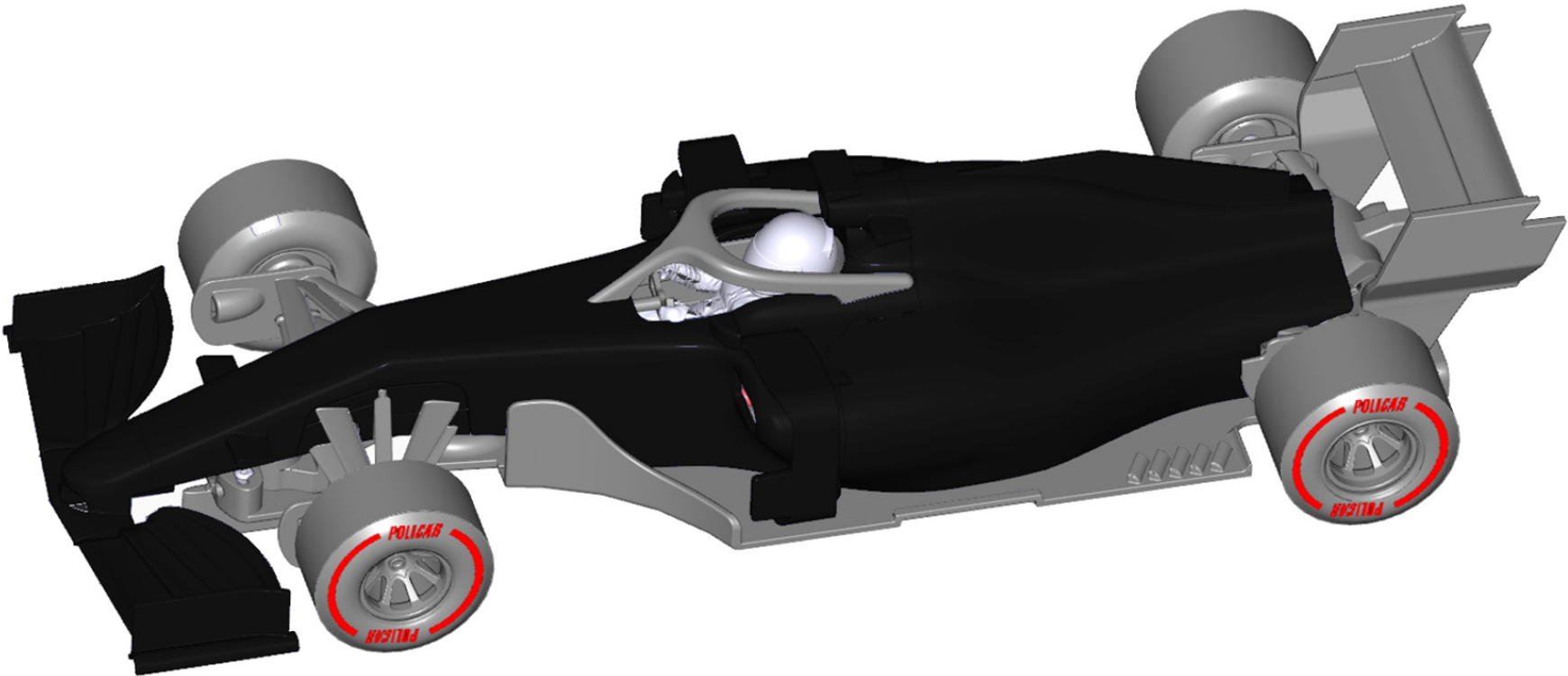







F1 Monoposto

Black Body

CAR07-black

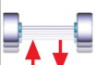
167 mm 32.5 mm 108 mm 60 mm 58 g

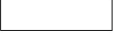
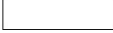

	Motor Mount Type B	Motro Mount Type C	Pinion/Gear	Setup	ND Magnet	Front Rims/Tyres	Rear Rims/Tyres	Digital	Scale
						surface tread 	surface tread 	 	1:32
Motor mount	X	●	Z ₁ :9 Z ₂ :25/16 Z ₃ :17	●	X	11.5x20 PPT1354C1	14.25x20 PPT1224C1	○	

● Standard
○ Compatible
X Not compatible



miniature electric
motor racing



Pre assembled and pre painted Monoposto.
Endless painting possibilities.

Optional magnetic front wing clip - protects wing from breaking and realistic racing damage simulation!
(CN10 magnets must be bought separately)

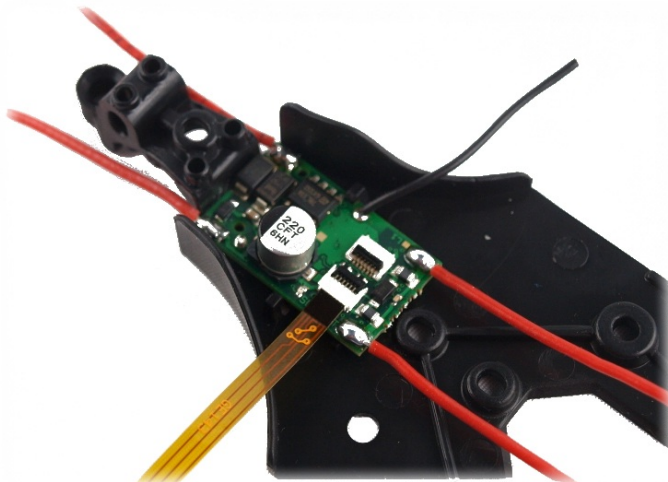

Two chassis for the price of one.
Get ready for digital action with the digital-ready chassis or do some modelling with the realistic appearance of a proper t-tray splitter chassis
(because everyone knows what a t-tray is, right?)

